

















LEGENDA SEGNI GRAFICI

-  QUADRO ELETTRICO
-  CONTATORE ENERGIA ELETTRICA
-  DORSALI PRINCIPALI
-  INTERRUTTORE COMANDO LUCI
-  CENTRO LUCE
-  PUNTO PRESA BIVALENTE
-  DOPPIO PUNTO PRESA BIVALENTE
-  PULSANTE CON TIRANTE E SUONERIA
-  LAMPADA EMERGENZA 60'
-  RILEVATORE DI PRESENZA
-  ALLARME
-  SIRENA DA INTERNO
-  SIRENA DA ESTERNO
-  TELECAMERA
-  PRESA RJ45

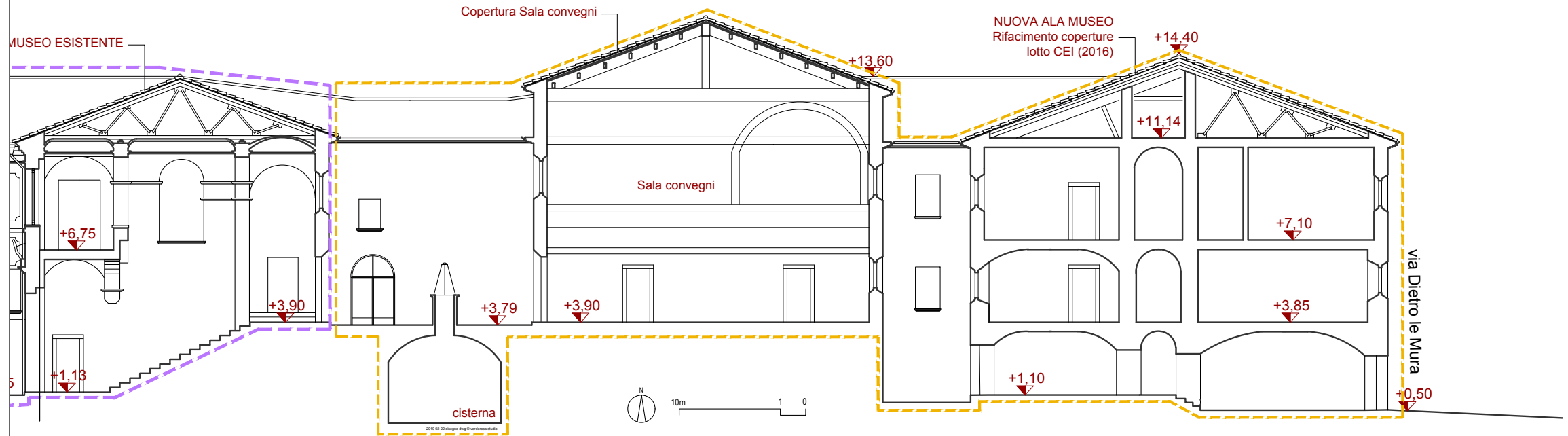

-  ex Seminario Arcivescovile
NUOVA ALA MUSEO
-  ex Palazzo Vescovile
MUSEO ESISTENTE

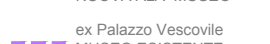

SEZIONE A-A

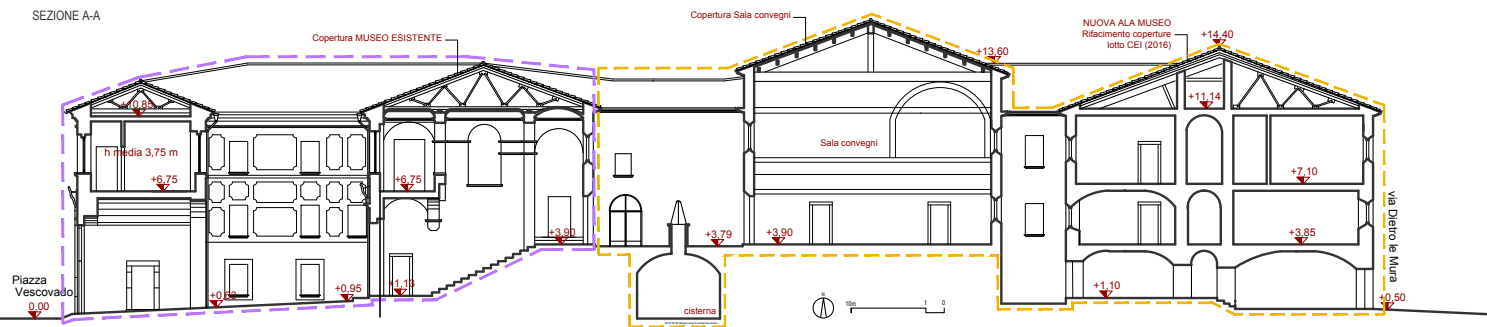

MUSEO e ARCHIVIO STORICO DIOCESANO
INSULA EPISCOPALE di NUSCO - Cittadella Museale - Rete Musei Campania

Comune di Nusco (Av) ente beneficiario finale
ARCIDIOCESI di SANT'ANGELO dei LOMBARDI ente concedente
 Soprintendenza ABAP di Salerno ed Avellino alta sorveglianza

PROGETTO ESECUTIVO

Supervisione artistica e museografica, committente Arcidiocesi, Mons. Tarcisio Luigi Gambalunga
 Direttore dell'Ufficio Beni Culturali
 Responsabile unico del procedimento, committente Arcidiocesi, geom. Luigi D'Angeli
 Direttore dell'Ufficio Tecnico Diocesano
 Progettista responsabile per la committente Arcidiocesi, fase di progettazione definitiva, arch. Lucia Turri
 Consulenza e progettazione definitiva
 allestimento e museografia nuova ala museo, arch. Lucia Turri
 completamento e museografia museo esistente, arch. Angelo Verderosa
 compiti e discipline tecnico-progettuali, arch. Antonio Ressa
 verifiche, consolidamenti statici e strutture, ing. Luciano De Mita
 impianti climatizzazione e idrico-fognari, ing. Flaminio Mazzariello
 impianti elettrici e opere correlate, ing. Enrico De Mita
 giovani professionisti: dot. in arch. Maria Bovio / arch. Isabella Petecca / arch. Benedetta Verderosa
 consulente per il restauro delle opere artistiche, Margherita Gramaglia
 responsabile dell'elaborato: arch. Angelo Verderosa / arch. Benedetta Verderosa

Settore elaborato
IMP.E Impianti Elettrici,
Videosorveglianza, Antieffr.

Cod. elaborato
IMP.E3.8

Titolo elaborato
Sezione

Verificato da: Ufficio Tecnico Diocesano, I.R.U.P.